

Ref. 2919 – **CASALE ANGHIARI**

www.romolini.com/en/2919

RESTORED COUNTRY HOUSE FOR SALE JUST 2 KM FROM THE CENTER OF ANGHIARI, TUSCANY

Anghiari – Arezzo – Tuscany



Interiors
275 m²

Bedrooms
3 (up to 5)

Bathrooms
2 (up to 4)

Total land
11,840 m²

Just 2 km from the charming medieval town of Anghiari, characteristic stone farmhouse for sale surrounded by greenery. The property is an ideal solution both as a private residence and accommodation business, thanks to the possibility of creating additional rooms in both the main house and the barn. The property is surrounded by a fenced garden of 11,800 m² with a small tree-covered yard, perfect for those who want privacy, tranquility and contact with nature.

SUMMARY OF THE PROPERTY

REFERENCE #: 2919 – CASALE ANGIARI

TYPE: rustic country house

CONDITIONS: restored

LOCATION: open and sunny

ACCESS: excellent, paved road

INTERIORS: 275 square meters (2,959 square feet)

TOTAL ROOMS: 14

BEDROOMS: 3 (up to 5)

BATHROOMS: 2 (up to 4)

ANNEXES: barn

MAIN FEATURES: stone and brick walls, wooden beams, ceramic and parquet flooring, fireplace, iron grates, barn to be restored, paved porch, original oven, fenced garden

EXTERIOR: 11,480 square meters (2.8 acres)

GARDEN: yes, well maintained and fenced

SWIMMING POOL: no, but possible

ELECTRICITY: already connected

WATER SUPPLY: mains water + private well

TELEPHONE: already connected

ADSL: yes

GAS: LPG

ENERGY CERTIFICATE:  (EP_{gl, nren} = 195.23 kWh/m²year)

HEATING SYSTEM: radiators

CLOSEST CITIES AND TOWNS

Historical center of Anghiari (2km; 2'), Citeria (5km; 10'), Sansepolcro (11km; 20'), Città di Castello (17km; 20'), Arezzo (29km; 30'), Umbertide (42km; 40'), Perugia (71km; 1h), Montepulciano (77km; 1h 10'), Assisi (88km; 1h 10'), Siena (95km; 1h 20'), Florence (107km; 1h 35'), Orvieto (133km; 1h 40')

CLOSEST AIRPORTS

Perugia San Francesco (70km; 55'), Firenze A. Vespucci (123km; 1h 25'), Pisa G. Galilei (183km; 2h 10'), Bologna G. Marconi (186km; 2h 10'), Roma Ciampino (255km; 2h 40'), Roma Fiumicino (269km; 2h 45')

CASALE ANGIARI

Just 2 km from the charming medieval town of **Anghiari**, characteristic **stone farmhouse** for sale surrounded by greenery. The property is an ideal solution both as a private residence and accommodation business, thanks to the possibility of creating additional rooms in both the main house and the barn.

The town of Anghiari has a supermarket (less than 3km from the house) and schools ranging from kindergarten to middle school (all within a few minutes' drive). For other stores and shopping centers, on the other hand, one only needs to reach **Sansepolcro** (less than a quarter-hour drive). The **Arezzo train station** (about 30') makes it possible to reach much of Italy conveniently thanks to daily connections.

The **farmhouse** (183 m² – 1,969 ft²), in excellent condition and already habitable, is on three levels. On the ground floor we find a cozy living room with fireplace, a dining room, the kitchen and a bathroom. A hallway leads to the second floor, which houses three bedrooms and a second bathroom. The attics, habitable for about 47 m², offer additional space to be used for service rooms and/or additional rooms.

Completing the property is a **barn** (92 m² – 990 ft²) on two levels, currently used as a warehouse, with the possibility of being restored and converted into an annex.

The two buildings are connected by a **porch** (65 m²), with a traditional wood-burning oven and a 120 m² paved yard ideal for convivial moments outdoors.

The property is surrounded by a **fenced garden of 11,800 m²** with a small tree-covered yard, perfect for those who want privacy, tranquility and contact with nature.

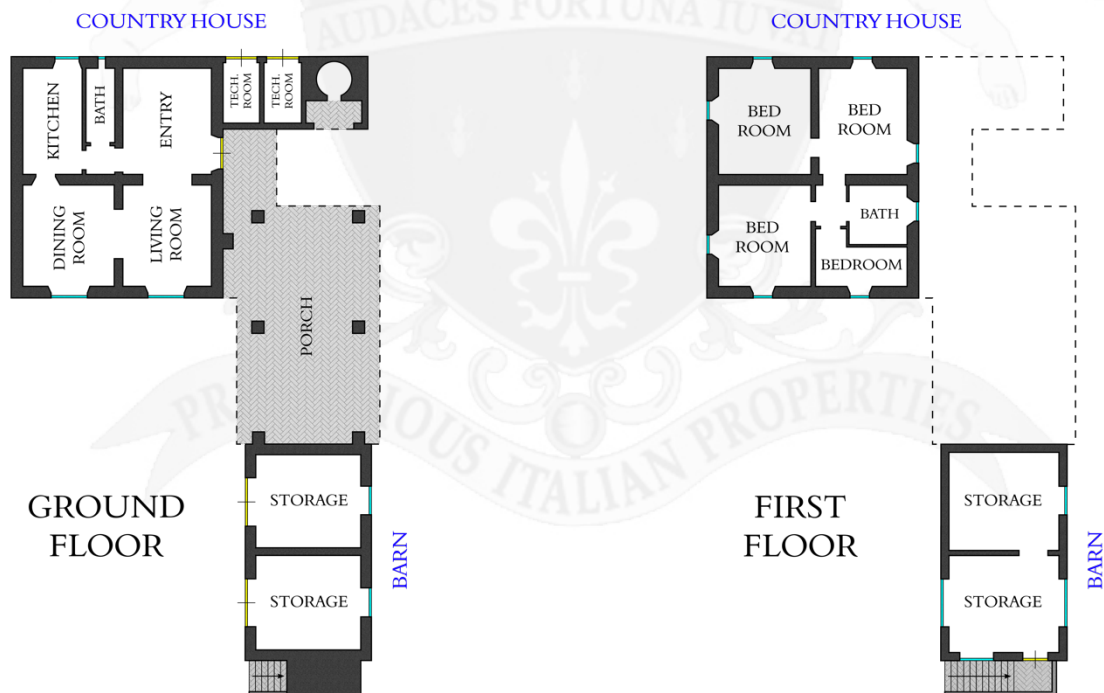



















ROMOLINI
IMMOBILIARE

CHRISTIE'S
INTERNATIONAL REAL ESTATE



ROMOLINI
IMMOBILIARE

CHRISTIE'S
INTERNATIONAL REAL ESTATE



ROMOLINI
IMMOBILIARE

CHRISTIE'S
INTERNATIONAL REAL ESTATE



ROMOLINI
IMMOBILIARE

CHRISTIE'S
INTERNATIONAL REAL ESTATE











ROMOLINI
IMMOBILIARE

RR
CHRISTIE'S
INTERNATIONAL REAL ESTATE

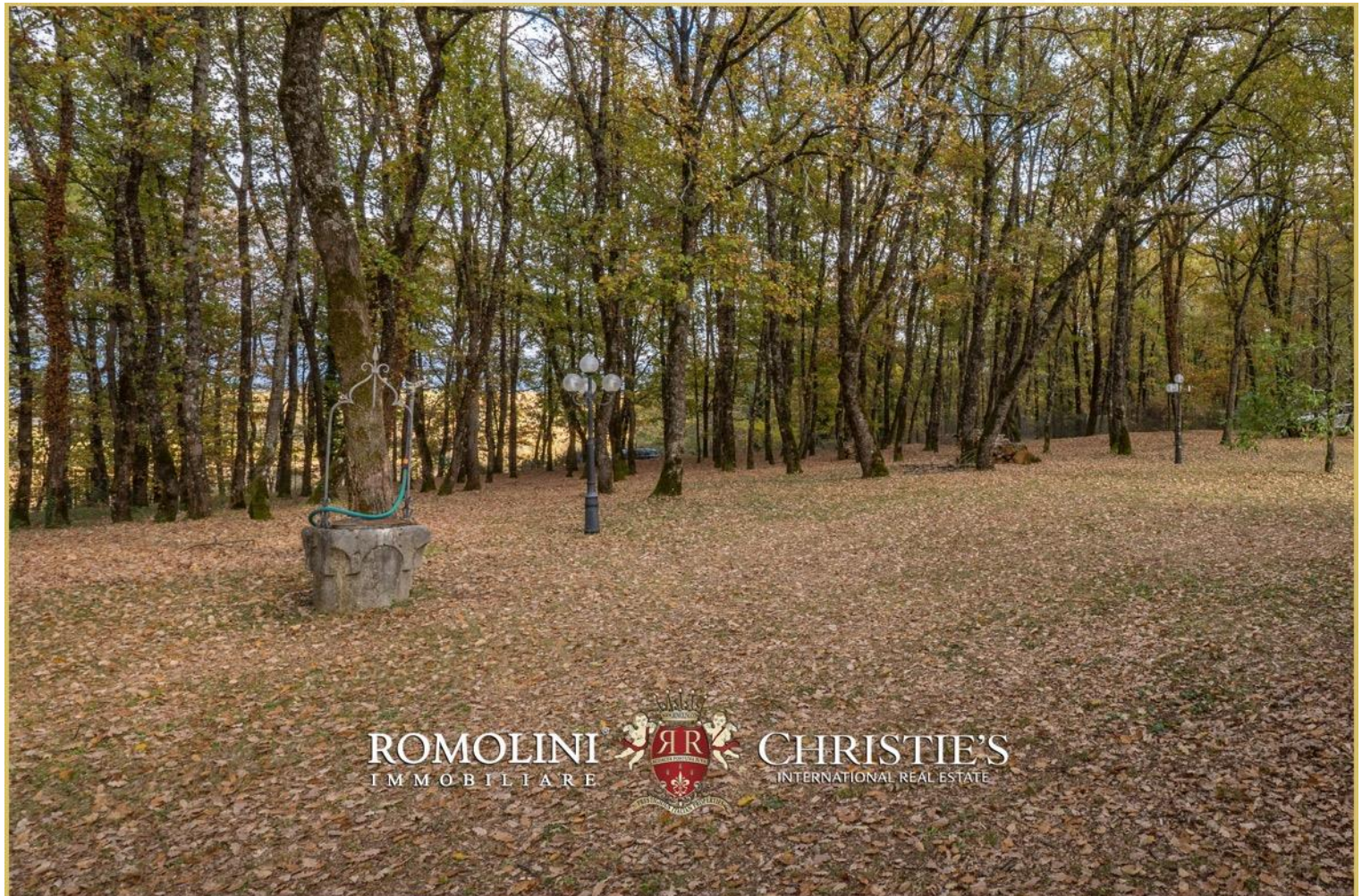

ROMOLINI
IMMOBILIARE

RR
CHRISTIE'S
INTERNATIONAL REAL ESTATE













































ROMOLINI
I M M O B I L I A R E

CHRISTIE'S
INTERNATIONAL REAL ESTATE

FIND US ON
INSTAGRAM

VISITE OUR
YOUTUBE CHANNEL

AGENZIA ROMOLINI IMMOBILIARE S.R.L.

Piazza Torre di Berta n. 4

52037, Sansepolcro (AR), Tuscany, Italia

(+39) 0575 788 948

www.romolini.com

info@romolini.com